



KAZAM Life B5

User Manual

ALL RIGHTS RESERVED

©2013 Kazam Mobile Ltd. All rights are reserved. Kazam, the Kazam logo and the Kazam icon are trademarks of Kazam Mobile Ltd. No part of this document can be reproduced without permission. All trademarks and brand names mentioned in this publication are property of their respective owners.

While all the efforts have been made to ensure the accuracy of contents in this manual, we presume no responsibility for errors or omissions or statements of any kind, whether such errors are omissions or statements resulting from negligence, accidents, or any other cause. We operate a policy of continuous development and reserve the right to make changes, modifications and improvements to the device, device features/specifications or any of its parts without prior notice.

Your device may have preinstalled bookmarks and links for third party internet sites and may allow you to access third party sites. These are not affiliated with us, and we do not endorse or assume liability for them. If you access such sites take precautions for security or content.

The limited warranty does not cover user manuals or any third party software, settings, content, data or links, whether included in, or downloaded to the product, whether included during installation, assembly, shipping or any other time in the delivery chain, or otherwise and in any way acquired by you. To the extent permitted by applicable law(s), we do not warrant that any of our software will meet your requirements, will work in combination with any hardware or software applications provided by a third party, that the operations of the software will be uninterrupted or error free or that any defects in the software are correctable or will be corrected.

- ✦ **User Manual is provided to guide the user about the functionality of the device. It does not constitute any certificate of technology. Some functions may vary due to modifications and upgrades of software, or due to printing mistake.**

SAFETY PRECAUTIONS

Please read the following safety guidelines before using the device.

- ✦ Do not use the mobile phone while you are driving.
- ✦ Do not place magnetic storage media near your mobile phone, as the magnetic force from the device may erase the information stored on it.
- ✦ Keep your mobile phone and its accessories away from children.
- ✦ Mobile phones can interfere with the functioning of medical devices such as hearing aids or pacemakers. People with active medical implants should keep their mobile phone at least 15 cm away from the implant.
- ✦ Permanent hearing loss may occur if you use earphones or headphones at high volume.

- ✦ Use a wireless hands-free system (headphone/ headset) with a low power Bluetooth emitter.
- ✦ Make sure the mobile phone has a low SAR.
- ✦ Keep your calls short or send a text message (SMS) instead. This advice applies specially to children adolescents and pregnant women.
- ✦ Use mobile phone when the signal quality is good.

Notice:

- ✦ Warranty is invalidated if the mobile phone or accessories are dismantled, the manufacturer will not be liable to pay for damages.
 - ✦ Only use original batteries and charging devices.
 - ✦ Back up important data regularly and store it properly. The manufacturer is not liable for any loss of data due to mis-operation, poor signal or power cut, etc.
 - ✦ All screen images in this manual are for reference only, content displayed may depend on the pre-setting of the service provider, the network operator or the SIM card. If any functions referred to in this manual are different from those of your device, please follow your device.
 - ✦ Do not put use it in a place with flammable gas such as a petrol pumps. The temperature recommended for using the device is 10-55 °C. Do not touch the charger, power cable or socket with wet hands. This may cause an electric shock.
 - ✦ Our cellular phones are in accordance with the communication industry standards of PRC, and also according in accordance with standards of European, and are approved for GSM networks.
 - ✦ Your phone may be used internationally with various networks depending on your roaming arrangements with your service provider.
 - ✦ Only use the chargers listed in the manufacturer's catalogue should be used. Using any other charger may be dangerous and would also invalidate your warranty. Line voltage must be exactly the one indicated on the charger's serial plate.
 - ✦ Your phone is a radio transmitter which may interfere with electronic medical equipment or implants, such as hearing aids, pacemakers, insulin pumps, etc. It is recommended that a minimum separation of 15cm be maintained between the phone and an implant.
- ✦ **If your mobile phone or any of its accessories do not function normally, please contact Kazam customer support. The qualified personnel will assist you, and if necessary will arrange for a repair.**

TABLE OF CONTENTS

ALL RIGHTS RESERVED	1
SAFETY PRECAUTIONS	2
TABLE OF CONTENTS	3
1. UNDERSTANDING YOUR DEVICE	5
1.1. GENERAL INFO	5
1.2. DEVICE OVERVIEW	5
2. GETTING STARTED	6
2.1. INSTALLING CARDS& BATTERY	7
2.2. POWERING ON/OFF THE DEVICE	7
3. BASIC OPERATIONS	7
3.1. CALLING	7
3.2. MESSAGING	8
3.3. PHONEBOOK	9
4. CALLS	11
5. SETTINGS	12
5.1. PHONE SETTINGS	12
5.2. NETWORK SETTINGS	12
5.3. SECURITY SETTINGS	12
5.4. CALL SETTINGS	13
5.5. CONNECTIVITY	14
5.6. RESTORE SETTINGS	14
6. PROFILES	14
7. MULTIMEDIA	15
7.1. CAMERA	15
7.2. IMAGE VIEWER	15
7.3. VIDEO RECORDER	15
7.4. MEDIA	16
7.5. SOUND RECORDER	16
7.6. FM RADIO	16
8. EXTRAS	17
8.1. CALCULATOR	17
8.2. ALARM	17
8.3. CALENDAR	17
8.4. WORLD CLOCK	18
8.5. BLUETOOTH	18
9. FILE MANAGER	18
10. SPECIFICATIONS	19

1. UNDERSTANDING YOUR DEVICE

1.1 GENERAL INFO

KAZAM Life B5 has a 2.4" QVGA screen with 240*320 resolution. It has a fixed focus front camera, an 1000mAh battery and expandable memory. It supports MMS, SMS and Bluetooth.

1.2 DEVICE OVERVIEW



- | | |
|------------------|---------------------|
| 1. Earphone port | 2. USB port |
| 3. Receiver | 4. Display screen |
| 5. Left key | 6. Right key |
| 7. Answer key | 8. Power on/off key |
| 9. Keyboard | 10. Camera |
| 11. Speaker | |

2. GETTING STARTED

2.1 INSTALLING SIM CARDS & BATTERY

Please switch off your device before removing the battery, inserting a SIM or memory card.

Installing Battery

To install the battery please follow the steps below:-

- ✦ Remove the back cover of the device.
- ✦ Hold the device with the front facing downwards.
- ✦ Insert the battery ensuring it is the correct way round.
- ✦ Replace the battery cover until it clicks into place.

Charging the Battery

The device prompts a warning tone and message indicating insufficient battery when the battery power is low. Please follow the instructions below to charge your device:-

- ✦ Plug the connector of the charger into the micro USB port on the device.
- ✦ Plug the charger into a standard AC wall outlet.

Charging.....  Fully Charged..... 

It is recommended to fully charge the battery before using the device for the first time.

Installing SIM Card

In order to install you SIM card, follow the steps below:-

- ✦ Remove the back cover of the device.
- ✦ Hold the device with the front facing downwards.
- ✦ Remove the battery.
- ✦ Insert the SIM card into the device as shown below.
- ✦ Replace the battery.
- ✦ Replace the battery cover until it clicks into place.



Installing Memory Card

Your device supports micro SD card, which is a multimedia memory card used to increase the memory of the device. The micro SD card is small and should be installed carefully to avoid any kind of damage. Please follow the steps below to install the memory card in the device:

- * Remove the back cover of the device.
- * Hold the device with the front facing downwards.
- * Remove the battery
- * Slot the micro SD card into the device as shown below.
- * Replace the battery.
- * Replace the battery cover until it clicks into place.

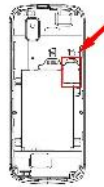

2.2 POWERING ON/OFF THE DEVICE

Turning On the Device

After installing the SIM card and charging the battery, you are now ready to turn on your device.

- * Press and hold the Power Key to turn on the device.

Turning Off the Device

- * Press and hold the Power Key for 3 seconds to enter the function screen, press the right navigator key to select power off.

3. BASIC OPERATIONS

3.1 CALLING

Making Calls

If the icon network strength is visible in the information bar at the top of the screen, then you can make or receive calls. To make a call, follow the steps below:

- * Direct dial
In standby mode, press the corresponding numeric keys to enter the phone number that you want to dial, including necessary area codes. Short Press the Right soft key [Clear] to delete.
- * International call
To make an international call, long press 0 key until the prefix symbol "+" of international call displays in screen.
- * Dialing from contact list

Enter the Phonebook via the menu, use the Up/Down Navigator keys to scroll to the desired contact, or press the first letter of the name of the desired contact for quick search.

- * Dialing from call history
Enter the Call centre (press the Green key from standby or via the menu), use the Up/Down navigator keys to scroll to the desired contact, press the green key can direct dial.

Answer/Reject an Incoming Call

When you receive an incoming call, details of the contact name/number are displayed.

Press the call key or left soft key to answer the incoming call.

Press the power key once to reject the call.

Other Options during the call

To put a call on hold

If you are on a call you can put the call on hold by selecting Options - Hold.

In call options menu:-

Swap –Switch between active calls

Conference – Multi-call options. The availability of this option depends on your service provider.

End single call - End the current call.

End all calls- End all active calls

New call – Launches the dialer and a new call can be initiated

Phonebook – Launched phonebook interface

Call history –Launched call history list

Messaging – Launches messaging menu

Sound recorder -Record the current call. Note-Recording of the call, in some countries is illegal. Therefore, when you record calls, should seek prior approval from the other party.

Mute – Open the function, the quiet do not send local voice.

Volume – Press the navigator to adjust the call volume.

3.2 MESSAGING

Your device is capable of sending and receiving of SMS (Short Message Service) and MMS (Multimedia Message Service).

Creating an SMS

- * From the main menu, select 'SMS' – 'Write message'
- * Select 'Options' – 'Send ' to enter a number or select a recipient contact
- * Once recipient is specified, select 'Options' – 'Send' to send the message.

Creating an MMS

Your device comes preloaded with some MMS settings. Additional settings can be added by accessing: –

Settings -> Connectivity -> Data Accounts -> Options -> Add PS Account

A multimedia message or MMS can contain letters, pictures, audio files or video files. To create and send a MMS follow the steps below:-

- ✦ From the main menu, select 'Messages' – 'Write message'
- ✦ Select 'Options' – 'Add picture' 'Add sound' 'Add video' to edit MMS
- ✦ Select 'Options' – 'Send to' to enter a number or select a recipient contact
- ✦ Select 'Options' to display MMS options where sounds, images and videos can be attached to the message.
- ✦ Once recipient is specified, select 'Options' – 'Send' to send the message.

Inbox

Received SMS and MMS messages are accessed here.

To open received messages highlight the message and select the centre key.

In message list, press the OK key to read the selected message or press the left soft key [Options] to launch the following menu:

View: view the current message

Reply: Reply SMS/MMS to the message sender directly.

Call Sender: Select to call the sender number.

Forward: forward the current message to other number.

Delete: Delete the highlighted message.

Delete all: Delete all messages in inbox.

Save to phonebook: Save the information in the sender number to the phonebook.

Mark as read/unread: Select the message to mark as read/unread

Advanced: Copy or move the one message or all message to phone.

3.3 PHONEBOOK

Contact details (name and number) are stored in the phonebook. You can save information such as name and phone number.

To add a Contact

- ✦ From the home screen press the right soft key or select 'Contacts' from the main menu.
- ✦ Press the left navigator key to 'Add new contact' option
- ✦ Select 'To SIM' or 'To Phone'.
- ✦ Enter contact information (Name and number)
- ✦ Select 'Options' – 'Save' to save the newly added contact.

Contact options

View: View the selected contact

Send message: Send SMS/MMS to the selected contact

Call: Call the selected contact

Edit: You can edit the details of the highlighted contact

Delete: Delete the highlighted contact

Copy: Copy the highlighted contact to "SIM" or "phone"

Move: Move the highlighted contact to "SIM" or "phone"

Send business card: Send the highlighted contact by SMS, MMS, Email or Bluetooth

Add to Blacklist: Add the highlighted contact to blacklist

Mark several: Mark one or several contacts to send or delete.

Phonebook settings

Speed dial - Contacts can be assigned to numbered shortcuts.

Use the OK key at 'Enable speed dial' option to turn speed dial function on or off. Select 'Set number', scroll to a key number (8 available, from 2 to 9), press the OK key and select 'Edit', scroll to the desired number to set as speed dial number for the key and press the OK key.

When a number is assigned to a speed dial and the function is enabled, you can simply press and hold the corresponding numeric key on idle screen to dial the assigned contact automatically.

My number – Store personal contact details here.

Extra numbers – Owner numbers, fixed dialing numbers and SOS numbers can be set and accessed here.

Memory status: View the used memory of the SIM card and phone's phone book. The capacity of SIM card depends on different SIM card.

Copy contacts: Contacts can be copied between SIM and Phone memories

Move contacts: Contacts can be moved between SIM and Phone memories

Delete all contacts: Select to delete the contacts from SIM or the phone memory.

4. CALLS

- ☛ All received calls, dialed numbers and missed calls as well as their call time are recorded in the call history section of your phone.
- ☛ Call history can be accessed by pressing the Green key from standby or accessed through the 'Call History' item through the main menu.

- ☛ If accessed through the menu item, Press the left/right navigator key, Switch to display list as follows:
 - ☛ All calls
 - ☛ Dialed calls
 - ☛ Missed calls
 - ☛ Received calls

All/Missed/dialed/Received

In the missed, dialed and received calls lists the following actions are applicable:-

- ☛ Green key – Make a call to the highlighted number/contact
- ☛ Centre key [OK]- View the details of highlighted call record
- ☛ Left soft key to launch the options menu as displayed below

View: View the details of current call record.

Call: call current record.

Send message: send SMS/MMS to the select number

Save to phonebook: Store the number as a phonebook entry.

Delete: Delete the current call record.

Delete call logs: You can select dialed calls/Missed calls/Received calls/All calls to delete.

5. SETTINGS

5.1 PHONE SETTINGS

☛ Time and date

Set home city: You can choose a home city from the list to set as the phone home time zone.

Set foreign city: You can choose a foreign city from the list to set as the phone foreign time zone.

Set time/date: Under this you can set the phone to the current date and time. The phone allows you to set the date range of calendar 2000 to 2030.

Set format: Under this you can set the time and date display format

☛ Schedule power on/off

A time can be set to ensure the handset powers on or off when desired.

☛ Language

Under this you can choose the language that the phone menus are displayed in.

☛ ShortCut Keys Manager

Home screen shortcuts can be set for easy access of specific features.

Shortcuts for single press and long press of the specified key can be allocated.

☛ Pref. input method

You can choose between ABC, abc or numeric as the default input method.

☛ Display

Wallpaper: The standby image displayed for background wallpaper.

You can choose from the built-in wallpaper and an image saved on the phone memory or memory card.

Screen auto lock

Under this you can set the time before the screen automatically locks. After the screen has automatically locked press the left soft key + * key to unlock.

Show date and time: You can set the idle screen time display on or off.

☛ Flight mode

Switch between normal and flight mode. When flight mode is active all network and data related functions will be restricted.

5.2 CALL SETTINGS

☛ Call waiting

You can choose to Activate, Deactivate or Query status of this feature.

If activated, you will be notified when a call is received whilst another call is ongoing.

☛ Call divert

This feature allows you to divert to your phone calls to your voice mailbox or another phone number you specify. This function needs the support of network operator.

✦ **Call barring**

Barring restrictions can be set on incoming and outgoing calls. This function needs the support of network operator, please contact the network operator for further information.

✦ **Advanced settings**

Blacklist

You can on or off this feature to edit the blacklist number, up to 20 numbers can be edited. Open the function, the blacklist numbers you call, the other shows you are on the phone, and your phone is in a state of no response

Auto redial

You can enable or disable this feature. If the feature is turned on then is a call is not successful then it will be automatically redialed up to 10 times.

Call time reminder

When set, an in call beep will sound after the selected time period. This can be after a specified number of seconds or you can select a time period after which the beep will sound.

Answer mode

Any key –When set, any key will answer incoming calls with the exception of the right soft key and the end key.

Auto answer when headset -When set, incoming calls will automatically be answered if a headset is inserted.

5.3 DATA SETTINGS

Set network related settings such as network selection and the use of GPRS. Automatic or manual network selection is available to determine the network that is camped onto.

5.4 SECURITY SETTINGS

✦ **SIM security**

You can set and enable the PIN code and PIN" codes
Note that if the input PIN code wrong three times, the SIM card will automatically lock and unlock and a PUK code will be required to unlock. Please contact your SIM card provider for more details regarding PUK codes.

PIN lock

Under this you can enable or disable PIN password. When this feature is enabled, every time you turn the phone prompts you to enter the PIN password.

Change PIN

If the current PIN password is already activated, you can make changes to the PIN password. First enter the old PIN password twice and then specify the desired, new

password for future use.

Change PIN2

PIN2password is used to access a particular function (such as setting a fixed number, set the call billing, etc.)

If PIN2 is entered incorrectly 3 times a PUK2 code will be required to unlock.

✦ **Phone security**

A phone passcode can be set to avoid unauthorised use of your mobile phone.

Phone lock

Under this you can enable or disable phone password. To do so, the phone password must be entered. **The default code is 0000.**

When this feature is enabled, every time you turn the phone on you are prompted to enter the password.

Change password

You can make changes to the phone password. First enter the old phone password, and then enter the newly selected password twice to confirm.

5.5 CONNECTIVITY

✦ **Data account**

Preloaded MMS accounts are displayed.

These accounts can be manually edited, deleted and added.

5.6 RESTORE FACTORY SETTINGS

Reset the phone settings to default using this feature. The phone password is required to use this feature.

Default password is 0000.

6. PROFILES

The phone provides you with four profiles: general, silent, meeting, outdoor. The profiles tailor the phone settings according to different environments by using a range of different tones and alerts. These profiles can be personalised according to your requirements.

7. MULTIMEDIA

7.1 CAMERA

Your phone is fitted with camera which allows you to take photos. You can store the pictures on the phone memory or on the inserted memory card.

- ✎ In the multimedia menu, select the camera to launch the camera preview screen.
- ✎ Press the OK key to take photo, press the right soft key to return, press the left soft key to launch the following options menu:

Camera Options

EV: press the left/right select EV.

Switch to: can directly switch from camera to video recorder/Photo album.

Capture mode: press the left/right navigation key to select capture mode as continuous shot, burst shot sel, smile shot

Scene mode: can set the photo mode as auto or night

Image size: press the left/right navigation key can set the image size.

Other settings: Press the left/right navigation key to adjust the following options, including Face detection, Self-timer, White balance, Effects, Storage, Image quality, Shutter sound, Anti-flicker, Contrast, Profile that is complete, press the left soft key or the OK key to confirm the current setting.

After taking pictures, press the back button to return camera preview screen, press the left soft key to enter options, can take pictures to forward, delete and Photo editor

7.2 IMAGES

This feature is convenient for users to view the photos stored in on the phone or memory card. Press the OK key to open the picture or press the left soft key to open the option menu:

View: Open the current image to view.

Image information: Display the current image information.

Edit: Add effects or resize the selected picture

Browse style: Select 'List style' or 'Matrix style' to activate the desired view for the image gallery.

Send : Pictures can be sent via "MMS" or "Bluetooth".

Use as: Picture can be set as idle screen wallpaper.

Rename: Change the name of the selected picture.

Delete : Delete the selected image.

Sort by : Choose to sort by image name, type, time or size

Delete all files: Select this to delete all the images from the gallery.

7.3 VIDEO RECORDER

- ✎ In the main menu, select the camera, press the left navigator key switch to the video preview screen
- ✎ Press the centre key to start recording
- ✎ Press up/down navigation key to adjust the focal distance
- ✎ Press the left soft key the launch the options menu

7.4 MEDIA

This feature can be used to play audio and video files stored on the phone memory or inserted memory card.

In Audio playing interface, press the OK key to start/pause the current song, press the down navigation key to stop play, press the left/right navigation key to switch previous/next song; Long press the left/right navigation key to pull the progress bar forward or backward press the */# key to adjust the volume, press the up navigation key into the audio file list. In playing interface, press the red key or the right soft key to exit player interface, Phone into the background playing mode, while the idle screen shows the name of the music.

In Video playing interface, press the OK key to start/pause the current video, press the left/right navigation key to switch previous/next video, Long press the left/right navigation key to pull the progress bar forward or backward; press "1" key or the up navigation key to switch full screen, press the */# key to adjust the volume, press the down navigation key to stop play.

7.5 RECORDER

Audio can be recorded through this feature.

- ✎ Press the left soft key [Options]
- ✎ Select 'New Record' and the recording starts.
- ✎ While recording is on progress, the OK key will pause and resume the recording and the down navigator key will stop the recording.
- ✎ While playing record is on progress, the up navigator will pause and resume the playing and the left/right navigator will switch previous or next record.

The recorded audio files can also be renamed, sent and deleted when the options in list view is accessed.

7.6 FM RADIO

You can use your mobile phone to listen to FM radio stations once a supported headset is plugged into the handset. Please press the side key to adjust music volume.

- ✎ Ensure headset in inserted
- ✎ Launch FM Radio from multimedia menu
- ✎ Press middle key to switch radio on and off.
- ✎ The up and down navigation keys manually scroll through radio frequencies.

☞ The left and right navigation keys scroll through radio stations.

Radio options menu

Channel list – Radio stations names and frequencies can be saved. When in FM

Radio pressing the corresponding key will tune into the specified frequency.

Manual input – Radio frequency can be manually entered.

Auto search – Automatically searches and saves the found frequencies.

8. ADDITIONAL FEATURES

8.1 CALCULATOR

Calculator helps you perform basic arithmetic functions, such as addition, subtraction, multiplication and division.

The navigation keys correspond to the arithmetic function displayed in the calculator display.

Left navigation key – Multiply

Right navigation key – Divide

Up navigation key – Add

Down navigation key – Subtract

Middle key – Equals

8.2 ALARM

Alarms can be set to sound at the specified time. To add a new alarm follow these steps:

- ☞ Launch the alarm feature through the menu
- ☞ Highlight an alarm and select 'Edit'.
- ☞ In the status menu select 'On'.
- ☞ Select time for alarm to sound and repeat value.
- ☞ Select 'Options' – 'Save' and alarm is set.

When an alarm is active a bell icon is displayed at the top of the idle screen and the alarm will be checked in the list.

8.3 CALENDAR

Calendar can be used to check the current date and plan events.

Calendar options

View: View the highlighted date and a list of associated appointments.

View all: View all of the saved entries in list view for all dates.

Add event: Launches the form to add an event to the calendar.

Delete event: Select to delete 'All', 'Overdue' entries or entries from a 'Specific period'.

Jump to date: Jump the selected date.

Go to today: the date of the input query calendar information

Go to weekly/monthly view: Can set the calendar display mode to show months or weeks.

8.4 WORLD CLOCK

In this menu, press the left / right navigation key to view the time zone of cities round the world.

8.5 BLUETOOTH

You can transfer data, such as images and videos to other devices using Bluetooth.

Search for devices and accept/transfer data. The received data is automatically stored in your phone.

Bluetooth options

Power: Switch Bluetooth on and off

Visibility: If your device is visible other Bluetooth devices can find the phone; if you select off, other Bluetooth devices can't find the phone.

My device: Select to add new equipment and search for Bluetooth devices within range of the signal. After the Bluetooth device is found, you can select the device you wish to connect with.

Search audio device: Initiate a search for BT audio devices

My name: Modify the Bluetooth device name that other users can identify your device with.

9. FILES

Files saved on the phone or memory card can be viewed and used here.

File manager options

- Open: Open the file or folder.

- New Folder – Create a new folder in which files can be stored

- Rename – The selected file or folder can be renamed.

- Delete – The selected file or folder can be deleted.

- Use as - If the selected file is an audio files it can be set as the ringtone for incoming calls. If the selected file is image file, it can be set as wallpaper.

- Sort by: can "name", "time", "size", "type" or "none".

- Send - The selected file can send by MMS or Bluetooth

- Copy: you can copy the select file to other folders.

- Move: you can move the select file to other folders.

- Details: you can view the select file information.

10. SPECIFICATION

Main Specification		Display	
GSM Bands(MHz)	850/900/1800/1900	Size	2.4
3G Bands(MHz)	900/2100	Type	TFT
		Resolution	240*320
Internal User Memory	128 ROM / 64 RAM	Camera	
SD Expandable to	8GB	Resolution	0.3M
SIM Card Slots Size(mm)	Single	Type	Fixed Focus
	119.5*48*11.5	Flash	NO
Weight with Battery	79.8g	Video	30FPS/30FPS
Connectivity			
Bluetooth	YES		
WIFI	NO		
USB	YES		
AUDIO	3.5MM jack		
Applications and Features			
MMS	YES		
WAP	YES		
Alarm	YES		
World Clock	YES		
Calendar	YES		
Games	NO		
Calculator	YES		
FM Radio	YES		
Torch	NO		
Charging/Battery/Certifications			
Charger	Type	USB	
	Removable	YES	
Battery	Type	Li-ion	
	Size	1000mAh	
	Standby time	300 hours	
	Talk Time	3.5 hours	

* The standby time and maximum talk time depend upon the network signals and settings.

ACCESSORIES

Use only batteries, chargers, and accessories approved by the manufacturer with this device. Use of any other types will invalidate the warranty and may be dangerous. Check with your dealer for available accessories. You may opt to buy:

Extra Battery

Extra batteries of various capacities are available from our company or through your dealer.

Charger Plug, charger cable

Charger plug used to connect with the charger cable for charging on wall outlets. Also you can use the charger cable to connect with the other devices such as the personal computers to charge the phone.

Charging time from empty is about 2 to 3 hours. The charging condition is displayed on screen. You may use your phone while charging.

Earphone

A mini, practical, hands-free device; you can use its button to answer and end calls. Do not plug or unplug the earphone when connecting dialed or incoming calls.

ENVIRONMENTAL CONCERN

Help us save the environment...GO GREEN!

All our endeavours are directed towards providing environmentally aware products to you. The materials used in our devices are recyclable and can be reused to make new products. We strive to make products that are safe for our consumers as well as the environment.

Preserve natural resources for future generations by recycling your mobile phone. Your mobile phone contains some metals which, when recycled properly, can be put back into circulation, decreasing the need for new metal mining.

Recycling reduces the need for raw materials, saves energy, helps mitigate global warming and reduces pollution, therefore preserving natural resources for the future.

Follow some simple steps and contribute towards saving the planet:

DO

- * Recycle your handset and its accessories.
- * To protect natural resources and to promote re-use of the material, kindly separate batteries from other type of waste.

DONT

- * Do not dispose of your mobile and its battery in fire.
- * Do not dispose your mobile with the regular waste.
- * Do not over charge your handset. Remove the charger when battery is full.



This logo signifies that this product and/or its accessories should not be disposed of with other household waste.

Hazards of improper handling, accidental breakage, damage and /or improper recycling of hazardous elements, can result in the following:

- ✦ When burned, cancer-producing dioxins can be released into the air we breathe; If thrown in landfills, leaching into groundwater affecting your local community
- ✦ In warm climates, the oxidation of mercury in the environment can be accelerated, leading to the creation of oxidized Hg atoms that are known to be associated with ozone depletion.
- ✦ Improper recycling additionally results in data security issues, as private electronic information remains on hard drive, if not properly removed before disposal.

How to Recycle

Please get your electronics products recycled only through authorised recyclers, approved by Pollution Control Board. We provide facility of recycling of our products, for details please visit our website or call our customer care. Help us to GO GREEN.

Constitution of Hazardous Elements in your Device:

Your device does not contain the following hazardous elements in a proportion higher than the limits provided hereunder: maximum concentration value of 0.1% by weight in homogenous materials for lead, mercury, hexavalent chromium, polybrominated biphenyls and polybrominateddiphenyl ethers; and maximum concentration value of 0.01% by weight in homogenous materials for cadmium.

EU Declaration of Conformity for R&TTE Directive 1999/5/EC

We [Kazam Mobile Limited](#)
Of [Suite 4B, 43 Berkeley Square, London, W1J 5FJ, United Kingdom](#)

Declare under our sole responsibility that the product

Product name: **Feature phone**

Trade name: [KAZAM](#)

Model name: [Life B5](#)

(Detailed description of product including name, type, model and supplementary Information such as lot, batch or serial number, sources and number of items) To which this declaration relates, is in conformity with the following standards And/or other normative documents.

Specification/Standards	Document Identification
ETSI EN 300 328 V1.8.1 (2012-06)	RSZ140702001-22A
ETSI EN 301 908-1 V6.2.1 (2013-04) ETSI EN 301 908-2 V5.4.1 (2012-12)	RSZ140702001-22B
EN 301 511 V9.0.2 (2003-03)	RSZ140702001-11
ETSI EN 301 489-1 V1.9.2 (2011-09) ETSI EN 301 489-7 V1.3.1 (2005-11) ETSI EN 301 489-17 V2.2.1 (2012-09) ETSI EN 301 489-24 V1.5.1 (2010-10)	RSZ140702001-02
EN 60950-1:2006+A11:2009+A1:2010+A12:2011	RSZ140702001-03
EN 50360:2001+A1:2012	RSZ140702001-20
EN55013:2013 EN55020:2007+A11:2011 EN61000-3-3:2006+A1:2009+A2:2009 EN61000-3-3:2008	RSZ140702002-01

We hereby declare that (all essential radio test suites have been carried out and that) the above named product is in conformity to all the essential requirements Of Directive 1999/5/EC.

The Conformity assessment procedure referred to in Article 10 and detailed in Annex [III] or [IV] of Directive 1999/5/EC has been followed with the involvement of the following Notified Body(ies):

Bay Area Compliance Laboratories Corp.1274 Anvilwood Ave, Sunnyvale, CA 94089, U.S.A
Identification mark: 1313 the equipment will also carry the
(Notified Body number) class 2 equipment identifier

Signature:

Printed name/title: [Daniel Readman](#)/Manager

Date: 12/09/2014

Tel: +44 (0) 20 7491 6930

Address: Suite 4B, 43 Berkeley Square, London, W1J 5FJ, United Kingdom

C€1313

SAR Information

Head: 0.219W/kg 10g

Body: 0.546 W/kg 10g

Body-worn Operation

This device was tested for typical body-worn operations. To comply with RF exposure requirements, a minimum separation distance of 1.5 cm must be maintained between the user's body and the handset, including the antenna. Third-party belt-clips, holsters, and similar accessories used by this device should not contain any metallic components. Body-worn accessories that do not meet these requirements may not comply with RF exposure requirements and should be avoided.

Use only the supplied or an approved antenna. Unauthorized antennas, modifications, or attachments could impair call quality, damage the phone, or result in violation of regulations. Do not use the phone with a damaged antenna. If a damaged antenna comes into contact with the skin, a minor burn may result. Please contact your local dealer for replacement antenna.